

PROFILE 16TH ST
 Scale = 1" = 10' Vert. 1" = 20' Hor.

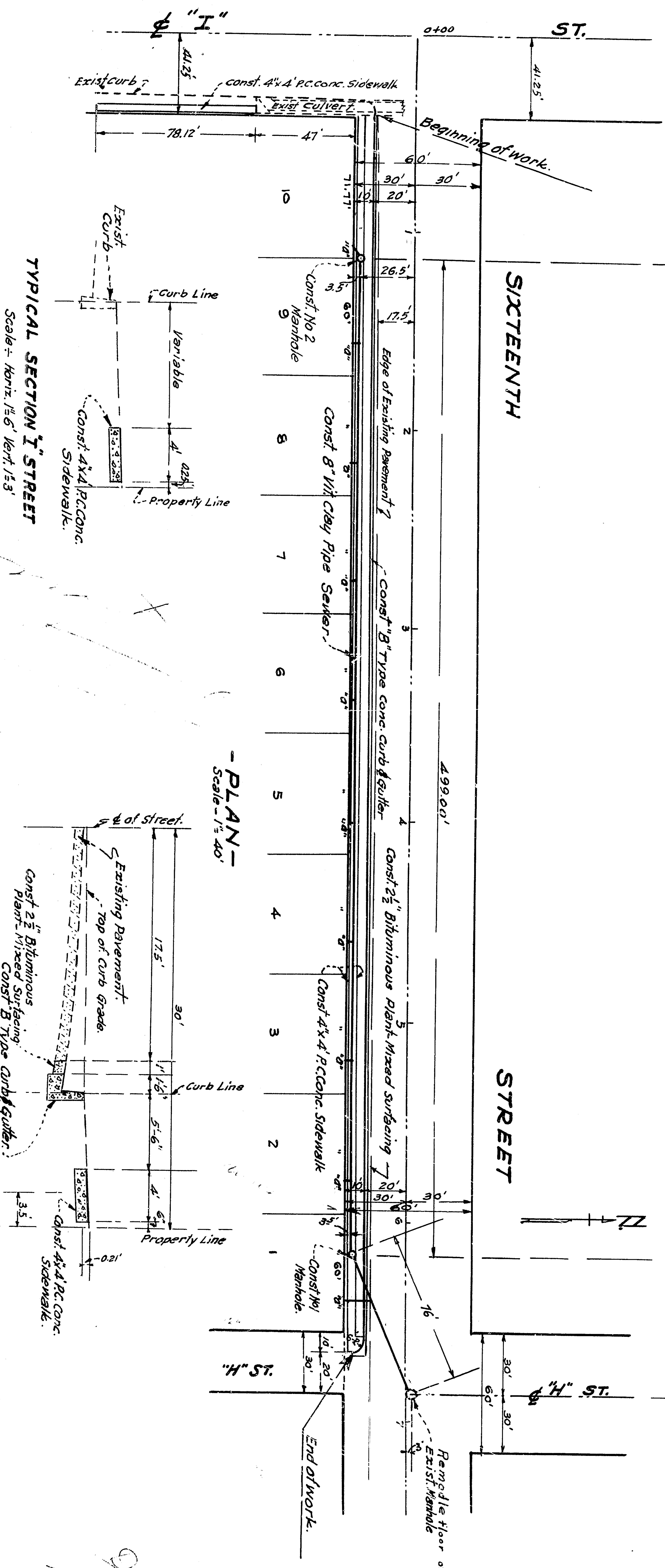

PLAN
 Scale = 1" = 40'

TYPICAL SECTION 1 STREET
 Scale = Horiz. 1" = 6' Vert. 1" = 3'

TYPICAL SECTION 16TH STREET
 Scale = 1" = 6' Horiz. 1" = 3' Vert.

NOTE: All work embodied on these plans shall be done in conformity with applicable provisions of Specifications 115 2027. Drivers/contractors shall depress curbs & sidewalks to form one (1) foot above concrete. All pipe shall be installed at least 18" below sidewalk. All work shall be done in conformity with applicable provisions of Specifications 115 2027. Drivers/contractors shall depress curbs & sidewalks to form one (1) foot above concrete. All pipe shall be installed at least 18" below sidewalk. All work shall be done in conformity with applicable provisions of Specifications 115 2027.

DEPARTMENT OF ENGINEERING
 CITY OF SAN BERNARDINO
 IMPROVEMENT PLANS - TR. 4092
 16TH STREET
 PAVING, CURB, GUTTER, AND SEWER
 BETWEEN "H" STREET & "I" STREET
 DRAWING NO. 2098
 SHEET 1 OF 1
 SUBMITTED BY: [Signature]
 APPROVED: [Signature]
 REGISTERED CIVIL ENGINEER NO. [Number]



PROFILE 16TH ST
 Scale = 1" = 4' Vert. 1" = 20' Hor.

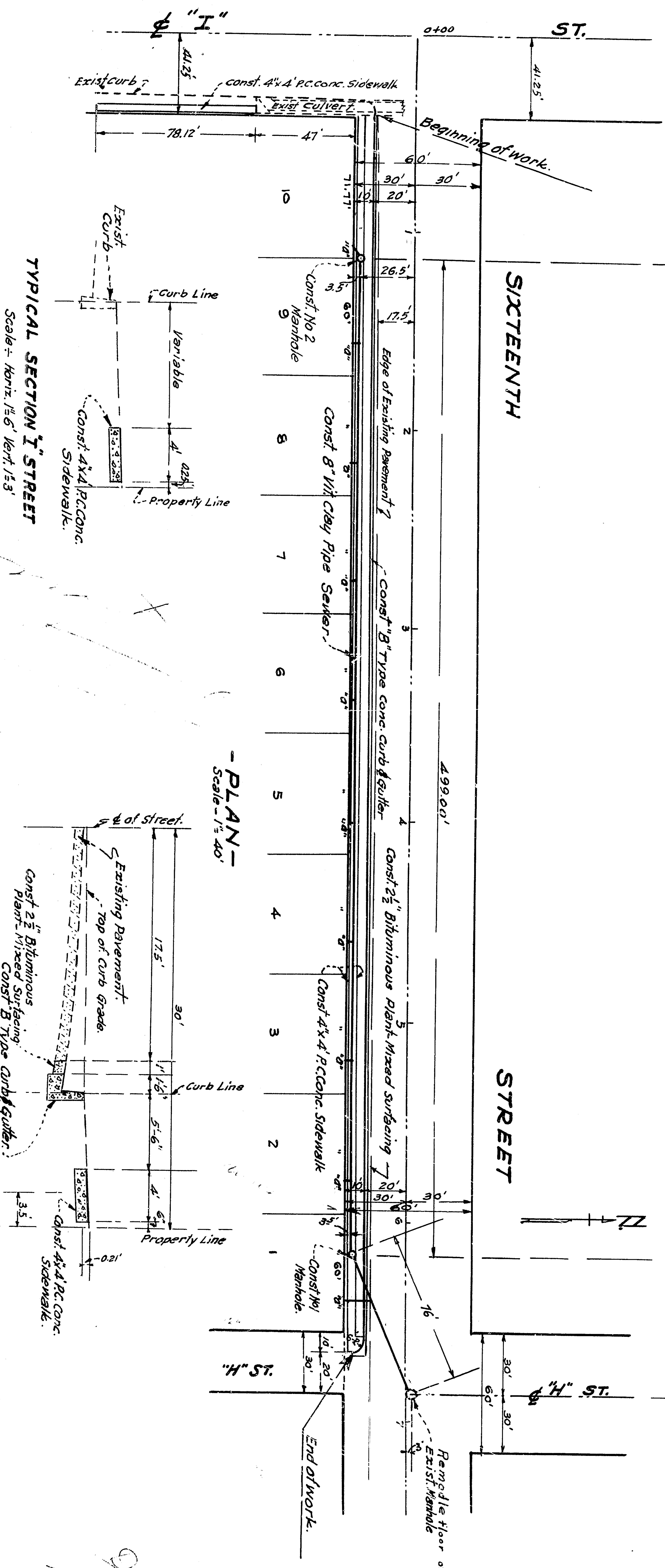

- PLAN -
 Scale = 1" = 40'

TYPICAL SECTION 1ST STREET
 Scale = Horiz. 1" = 6' Vert. 1" = 3'

TYPICAL SECTION 16TH STREET
 Scale = 1" = 6' Horiz. 1" = 3' Vert.

NOTE: All work embodied on these plans shall be done in conformity with applicable provisions of Specifications 115 2027. Drivers/contractors shall depress curbs & sidewalks to form one (1) foot above concrete. All pipe shall be installed at least 12" above sidewalk.

DEPARTMENT OF ENGINEERING
 CITY OF SAN BERNARDINO
IMPROVEMENT PLANS - TR. 4092
16TH STREET
PAVING, CURB, GUTTER, AND SEWER
BETWEEN 1ST STREET & 1ST STREET
 DRAWING NO. 2098
 SHEET 1 OF 1
 REGISTERED CIVIL ENGINEER NO. 19
 DESIGNED BY: [Signature]
 CHECKED BY: [Signature]
 APPROVED BY: [Signature]

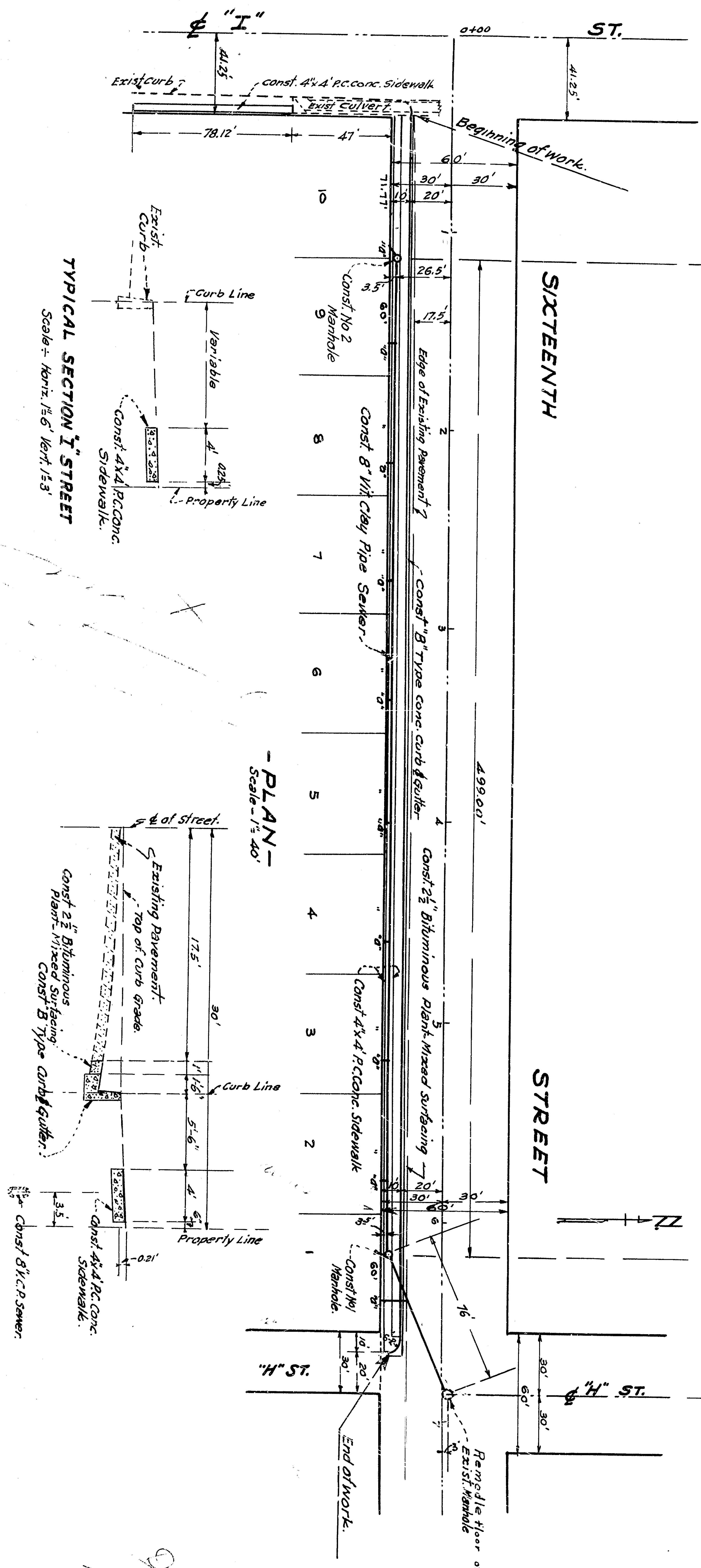


NOTE: All work embodied on these plans shall be done in conformity with applicable provisions of Specifications 115 2027. Drivers/contractors shall depress curbs & sidewalks to form one (1) foot above concrete. All pipe shall be installed at least 18\"/>

DEPARTMENT OF ENGINEERING
CITY OF SAN BERNARDINO
IMPROVEMENT PLANS - TR. 4092
16th STREET
PAYING CURB, GUTTER, AND SEWER
BETWEEN "H" STREET & "I" STREET
DRAWING NO. 2098
SHEET 1 OF 2 SHEETS

ISSO